



ENDCAP ADJACENT TO OLD ORCHARD MALL. SPACE UP TO 4,615 SF & 1,139 SF.

WILMETTE COMMONS

60-126 SKOKIE BLVD, WILMETTE, IL
FOR LEASE



CONTACT: CHelsea HENDERSON chenderson@metrocre.com 847.337.5287 // **STEVEN BAER** sbaer@metrocre.com 847.412.9898

PROPERTY HIGHLIGHTS

- Just one block north of Old Orchard Shopping Center, at a bustling intersection
- Ideal for medical, fast casual, or fitness use
- Situated in a densely populated area with North Shore households averaging over \$154,000 in annual income within a 1-mile radius
- Pylon signage available, excellent visibility and easy access to parking

DEMOGRAPHICS

	1 MILE	3 MILES	5 MILES
TOTAL POPULATION	14,798	142,544	348,337
DAYTIME POPULATION	18,367	113,307	285,155
HOUSEHOLDS	5,671	52,171	130,769
AVG HH INCOME	\$154,630	\$193,827	\$170,066

TRAFFIC COUNTS

OLD ORCHARD RD	22,953 VPD
SKOKIE BLVD	18,755 VPD

AREA TENANTS INCLUDE

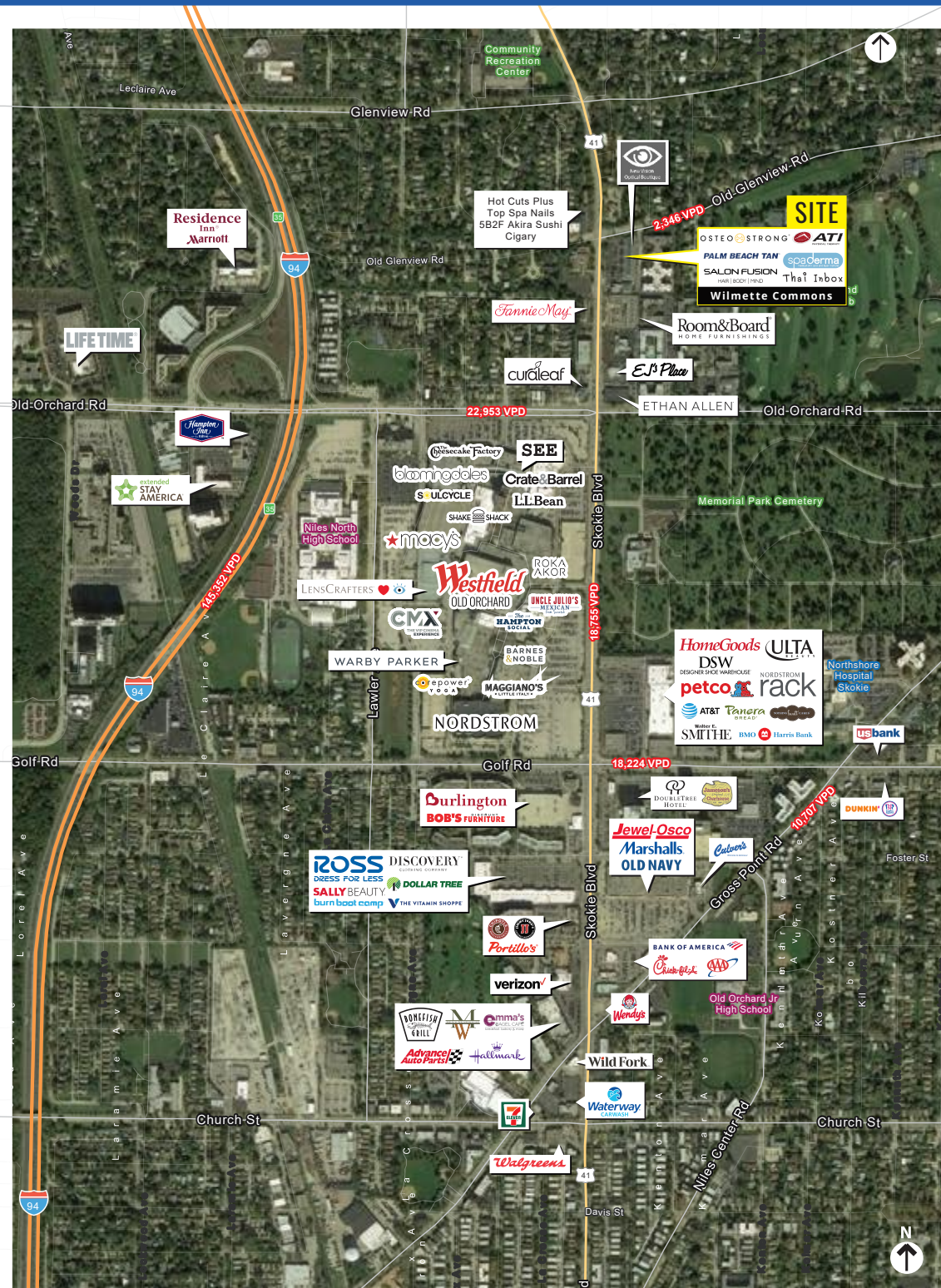

WILMETTE COMMONS

60-126 SKOKIE BLVD, WILMETTE, IL

FOR LEASE

SKOKIE BLVD | 18,755 VPD

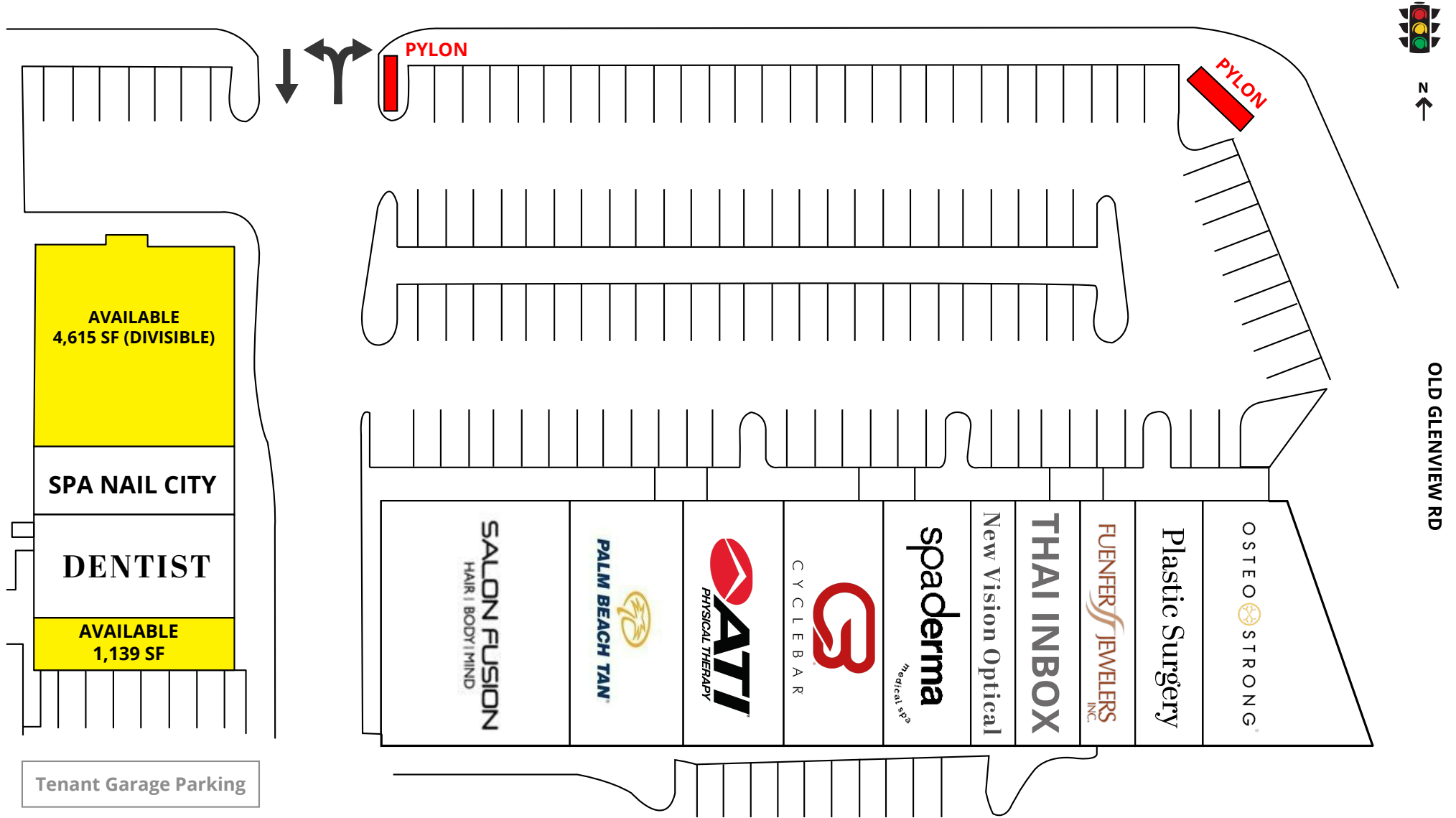

CONTACT
INFORMATION:

CHELSEA HENDERSON
chenderson@metrocre.com
847.337.5287

STEVEN BAER
sbaer@metrocre.com
847.412.9898

56 Skokie Valley Road
Highland Park, Illinois 60035
www.MetroCRE.com



WILMETTE COMMONS

60-126 SKOKIE BLVD, WILMETTE, IL

FOR LEASE

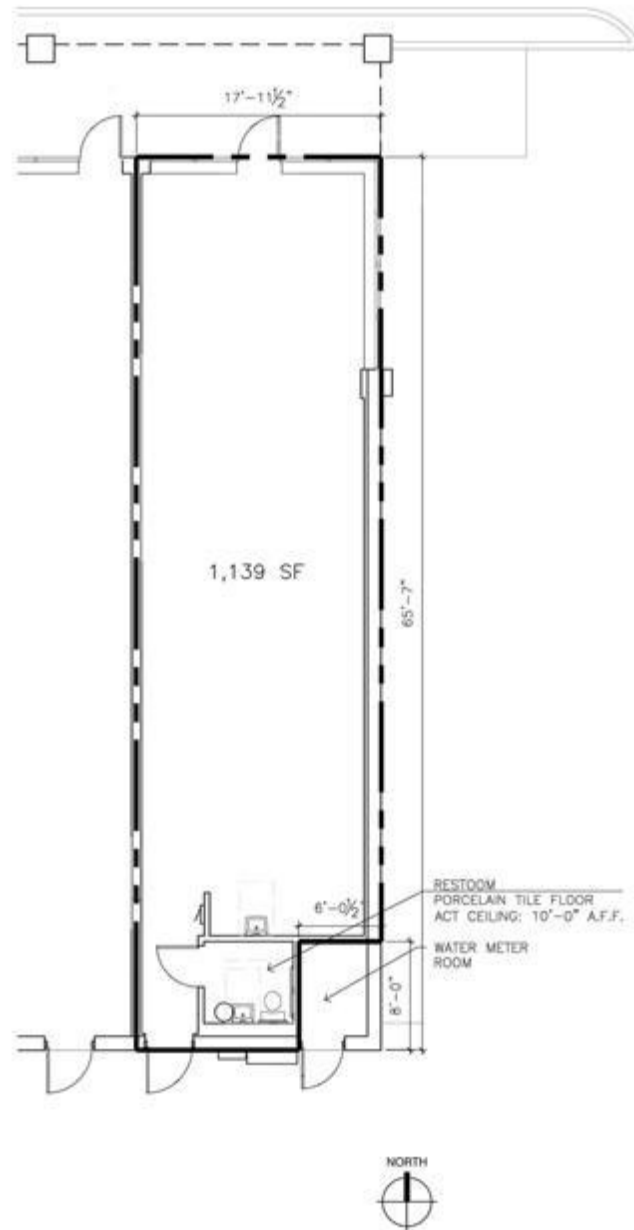

CONTACT
INFORMATION:

CHELSEA HENDERSON
chenderson@metrocre.com
847.337.5287

STEVEN BAER
sbaer@metrocre.com
847.412.9898

56 Skokie Valley Road
Highland Park, Illinois 60035
www.MetroCRE.com



METRO
COMMERCIAL REAL ESTATE